

February 2023

# London Luton Airport Expansion

Planning Inspectorate Scheme Ref: TR020001

Volume 4 Plans and Sections

**4.08 Streets, Rights of Way and Access Plans**

Application Document Ref: TR020001/APP/4.08

APFP Regulation: 5(2)(k)

The Planning Act 2008

The Infrastructure Planning (Applications: Prescribed Forms and Procedure) Regulations 2009

London Luton Airport Expansion Development Consent Order 202x

---

4.08 STREETS, RIGHTS OF WAY AND ACCESS PLANS

---

<b>Regulation number:</b>	Regulation 5(2)(k)
<b>Planning Inspectorate Scheme Reference:</b>	TR020001
<b>Document Reference:</b>	TR020001/APP/4.08
<b>Author:</b>	Luton Rising

<b>Version</b>	<b>Date</b>	<b>Status of Version</b>
Issue 1	February 2023	Application issue

# Contents

---

Page

## Contents

<b>1</b>	<b>STREETS, RIGHTS OF WAY AND ACCESS PLANS</b>	<b>1</b>
1.1	Purpose of this document	1
1.2	Scope and format of the Streets, Rights of Way and Access Plans	1
1.3	Streets, Rights of Way and Access Plans List	1

## 1 STREETS, RIGHTS OF WAY AND ACCESS PLANS

### 1.1 Purpose of this document

- 1.1.1 Luton Rising (a trading name of London Luton Airport Limited), owners of London Luton Airport (the Applicant) has submitted an application under section 37 of the Planning Act 2008 for an order to grant development consent for the expansion of London Luton Airport (the Proposed Development).
- 1.1.2 This document is part of a suite of documents which forms part of the application for development consent. A full description of all the Application Documents is provided in the **Introduction to the Application [TR020001/APP/1.03]** which also forms part of the suite of application documents.
- 1.1.3 This document is included in the application to comply with Regulation 5(2)(k) and Regulation 5(4) of the Infrastructure Planning (Applications: Prescribed Forms and Procedures) Regulations 2009 (“the 2009 Regulations”), which requires:
- a) 5(2)(k) ‘where applicable, a plan identifying any new or altered means of access, stopping up of streets or roads or any diversions, extinguishments or creation of rights of way or public rights of navigation’
- 1.1.4 Regulation 5(4) requires that ‘Where a plan comprises three or more separate sheets a key plan must be provided showing the relationship between the different sheets’.
- 1.1.5 Accordingly, a key plan is submitted as part of the application to identify the location of the streets, rights of way and access in relation to the geographical context of the Proposed Development.
- 1.1.6 As this document is part of the application documentation, it should be read alongside, and is informed by, the other application documents. In particular, the plans should be read alongside Schedules 3 of the **draft Order [TR020001/APP/2.01]**.

### 1.2 Scope and format of the Streets, Rights of Way and Access Plans

- 1.2.1 The purpose of the Streets, Rights of Way and Access Plans is to show streets, rights of way and private means of accesses that are to be stopped up, diverted or created, and public or private rights of way that are to be diverted, extinguished or created. The terms ‘street’ includes highways and other streets.
- 1.2.2 The Streets, Rights of Way and Access Plans use a smaller scale of 1:5000, than that prescribed in Regulation 5(3) of the 2009 Regulations but only so that the Proposed Development can be represented in a single sheet plan as a helpful aid.

### 1.3 Streets, Rights of Way and Access Plans List

Streets, Rights of Way and Access Plans Drawing Name	Drawing Number	Work No.
Rights of Way Plans- Permanent Stopping Up Of Public Rights Of Way- Keyplan	LLADCO-3C-ARP-SFA-SWI-DR-HY-0100	Overview
Rights of Way Plans- Permanent Stopping Up Of Public Rights Of Way (Sheet 1 of 6)	LLADCO-3C-ARP-SFA-SWI-DR-HY-0006	N/A
Rights of Way Plans- Permanent Stopping Up Of Public Rights Of Way (Sheet 2 of 6)	LLADCO-3C-ARP-SFA-SWI-DR-HY-0007	N/A
Rights of Way Plans- Permanent Stopping Up Of Public Rights Of Way (Sheet 3 of 6)	LLADCO-3C-ARP-SFA-SWI-DR-HY-0008	N/A
Rights of Way Plans- Permanent Stopping Up Of Public Rights Of Way (Sheet 4 of 6)	LLADCO-3C-ARP-SFA-SWI-DR-HY-0009	N/A
Rights of Way Plans- Permanent Stopping Up Of Public Rights Of Way (Sheet 5 of 6)	LLADCO-3C-ARP-SFA-SWI-DR-HY-0010	N/A
Rights of Way Plans- Permanent Stopping Up Of Public Rights Of Way (Sheet 6 of 6)	LLADCO-3C-ARP-SFA-SWI-DR-HY-0011	N/A
Rights of Way Plans- Public Rights Of Way Proposals- Keyplan	LLADCO-3C-ARP-SFA-SWI-DR-HY-0200	Overview
Rights of Way Plans- Public Rights Of Way Proposals (Sheet 1 of 3)	LLADCO-3C-ARP-SFA-SWI-DR-HY-0012	5b(03), 5b(04), 5b(05), 5b(06), 5b(07)



Rights of Way Plans- Public Rights Of Way Proposals (Sheet 2 of 3)	LLADCO-3C-ARP-SFA-SWI-DR-HY-0013	5b(05), 5b(06)
Rights of Way Plans- Public Rights Of Way Proposals (Sheet 3 of 3)	LLADCO-3C-ARP-SFA-SWI-DR-HY-0014	5b(04)
Streets, Rights of Way and Access Plan- Airport Access Road- Keyplan	LLADCO-3C-ARP-SFA-SWI-DR-HY-1500	Overview
Streets, Rights of Way and Access Plan- Airport Access Road (Sheet 1 of 3)	LLADCO-3C-ARP-SFA-HWM-DR-HY-1505	6a(02), 6a(03)
Streets, Rights of Way and Access Plan- Airport Access Road (Sheet 2 of 3)	LLADCO-3C-ARP-SFA-HWM-DR-HY-1506	6a(02), 6a(03)
Streets, Rights of Way and Access Plan- Airport Access Road (Sheet 3 of 3)	LLADCO-3C-ARP-SFA-HWM-DR-HY-1507	6a(02), 6a(03)
Streets, Rights of Way and Access Plan- Airport Roads (Sheet 1 of 2)	LLADCO-3C-ARP-SFA-HWM-DR-HY-1508	6b(02), 6b(03), 6c(03)
Streets, Rights of Way and Access Plan- Airport Roads (Sheet 2 of 2)	LLADCO-3C-ARP-SFA-HWM-DR-HY-1509	6a(02), 6b(03)

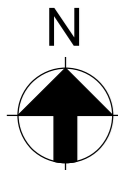

Eaton Green Road

LLADCO-3C-ARP-SFA-SWI-DR-HY-0006  
(Sheet 1)

LLADCO-3C-ARP-SFA-SWI-DR-HY-0007  
(Sheet 2)

LLADCO-3C-ARP-SFA-SWI-DR-HY-0008  
(Sheet 3)

LLADCO-3C-ARP-SFA-SWI-DR-HY-0009  
(Sheet 4)

LLADCO-3C-ARP-SFA-SWI-DR-HY-0010  
(Sheet 5)

LLADCO-3C-ARP-SFA-SWI-DR-HY-0011  
(Sheet 6)

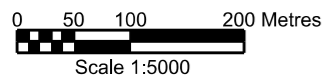

This drawing may contain mapping by permission of Ordnance Survey on behalf of HMSO © Crown Copyright and database rights 2022 Ordnance Survey 0100031673

All structure positions are indicative. The proposed works will be subject to detailed design development. The changes will be within limits of deviation specified in the Development Consent Order.

## NOTES

- For Public Rights of Way to be stopped up, see LLADCO-3C-ARP-SFA-SWI-DR-HY-0006 to -0011

DCO Submission	NS	JR	RG	27/02/23	P01
Revision History	Drawn	Checked	Approved	Date	Rev.

Luton Rising  
Hart House Business Centre  
Kimpton Road, Luton, LU2 0LA  
www.lutonrising.org.uk

## London Luton Airport Development Consent Order

Drawing Title

**RIGHTS OF WAY PLANS  
PERMANENT STOPPING UP OF  
PUBLIC RIGHTS OF WAY  
KEYPLAN**

Purpose of issue				Suitability	
<b>DCO SUBMISSION</b>				S6	
Drawn	Checked	Approved	Date	Scale	Size
N.Scott	J.Riat	R.Goodall	27/02/23	1:5000	A3
DCO Application Ref.		APFP Regulation		DCO Document Ref.	
TR020001		5(2)(k)		TR020001/APP/4.08	
Drawing Number					Revision
<b>LLADCO-3C-ARP-SFA-SWI-DR-HY-0100</b>					<b>P01</b>
Project - Phase - Originator - Asset/Zone - Sub Asset - Type - Discp. - Number					

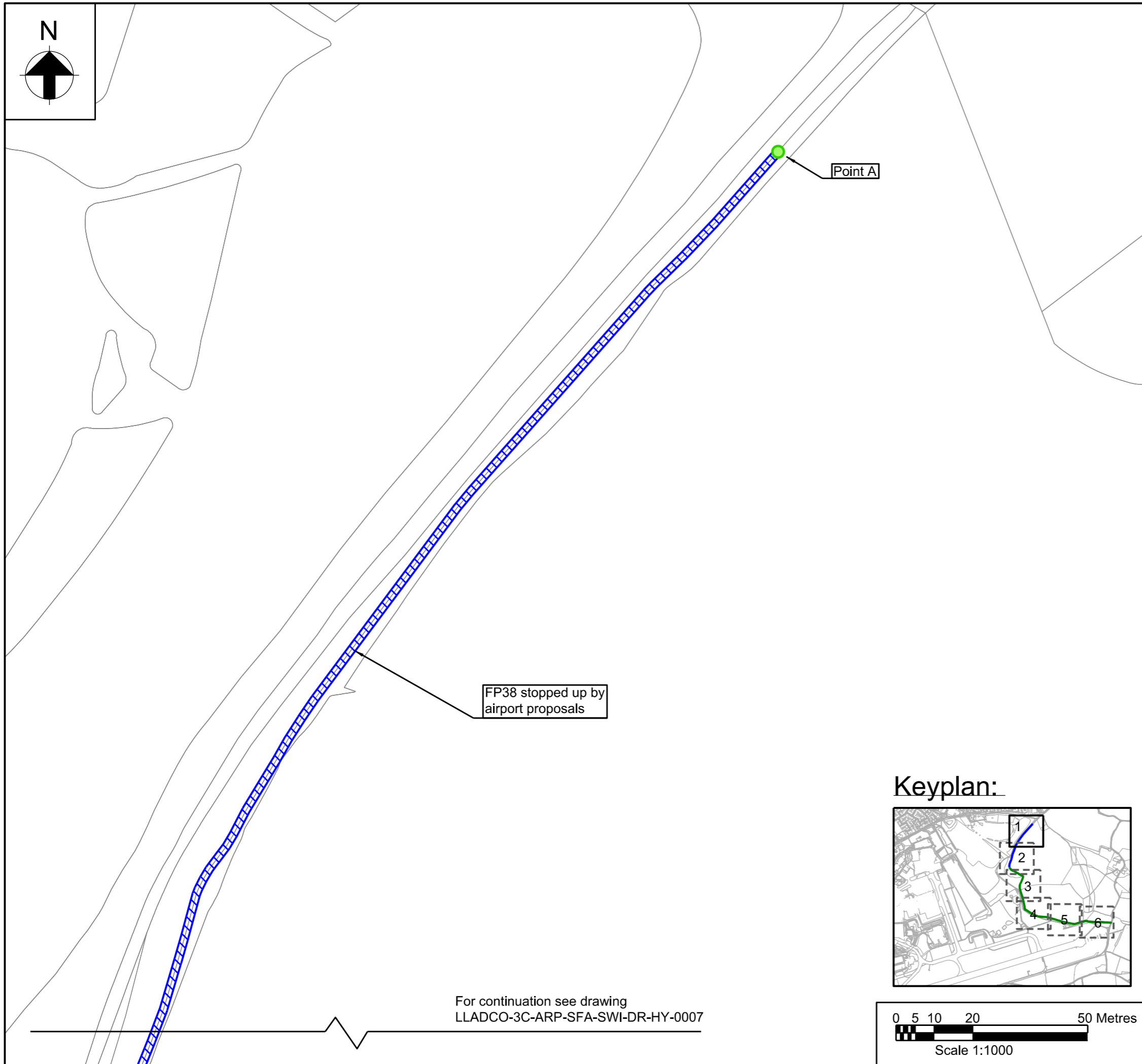
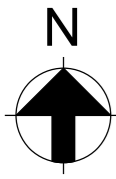

For continuation see drawing  
LLADCO-3C-ARP-SFA-SWI-DR-HY-0007

**Keyplan:**

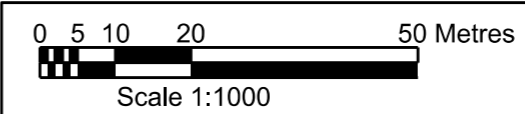
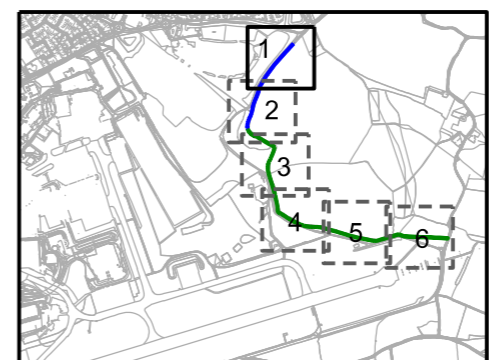

This drawing may contain mapping by permission of Ordnance Survey on behalf of HMSO © Crown Copyright and database rights 2022 Ordnance Survey 0100031673 □  
All structure positions are indicative. The proposed works will be subject to detailed design development. The changes will be within limits of deviation specified in the Development Consent Order.

**KEY**

- Public Footpaths to be Stopped Up
- Public Bridleways to be Stopped Up

**NOTES**

1. Points shown on drawing relate to DCO Schedule 3 reference

DCO Submission	NS	JR	RG	27/02/23	P01
Revision History	Drawn	Checked Approved	Date	Rev.	

Luton Rising  
Hart House Business Centre  
Kimpton Road, Luton, LU2 0LA  
www.lutonrising.org.uk

**London Luton Airport Expansion  
Development Consent Order**

Drawing Title  
**RIGHTS OF WAY PLANS  
PERMANENT STOPPING UP OF  
PUBLIC RIGHTS OF WAY  
- SHEET 1 OF 6**

Purpose of issue <b>DCO SUBMISSION</b>				Suitability S6	
Drawn N.Scott	Checked J.Riat	Approved R.Goodall	Date 27/02/23	Scale 1:1000	Size A3
DCO Application Ref. TR020001		APFP Regulation 5(2)(k)	DCO Document Ref. TR020001/APP/4.08		

Drawing Number <b>LLADCO-3C-ARP-SFA-SWI-DR-HY-0006</b>	Revision <b>P01</b>
Project - Phase - Originator - Asset/Zone - Sub Asset - Type - Discp. - Number	

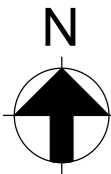

For continuation see drawing  
LLADCO-3C-ARP-SFA-SWI-DR-HY-0006

FP38 stopped up by  
airport proposals

Point B

FP29 stopped up by  
airport proposals

Point C

BW28 stopped up by  
airport proposals

Point D

BW37 stopped up by  
airport proposals

Keyplan:

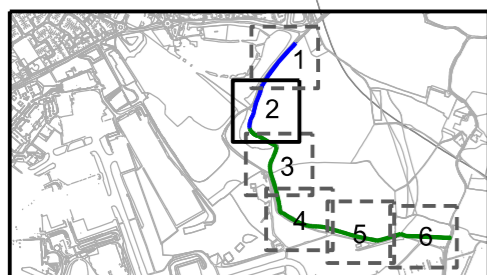

For continuation see drawing  
LLADCO-3C-ARP-SFA-SWI-DR-HY-0008

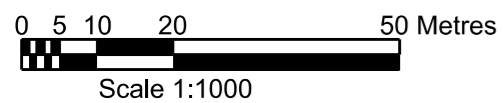

This drawing may contain mapping by permission of Ordnance Survey on behalf of HMSO © Crown Copyright and database rights 2022 Ordnance Survey 0100031673

All structure positions are indicative. The proposed works will be subject to detailed design development. The changes will be within limits of deviation specified in the Development Consent Order.

### KEY

- Public Footpaths to be Stopped Up
- Public Bridleways to be Stopped Up

### NOTES

1. Points shown on drawing relate to DCO Schedule 3 reference

DCO Submission	NS	JR	RG	27/02/23	P01
Revision History	Drawn	Checked	Approved	Date	Rev.



Luton Rising  
Hart House Business Centre  
Kimpton Road, Luton, LU2 0LA  
www.lutonrising.org.uk

## London Luton Airport Expansion Development Consent Order

Drawing Title  
**RIGHTS OF WAY PLANS  
PERMANENT STOPPING UP OF  
PUBLIC RIGHTS OF WAY  
- SHEET 2 OF 6**

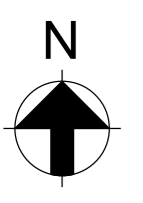

Purpose of issue				Suitability	
<b>DCO SUBMISSION</b>				S6	
Drawn	Checked	Approved	Date	Scale	Size
N.Scott	J.Riat	R.Goodall	27/02/23	1:1000	A3
DCO Application Ref.		APFP Regulation		DCO Document Ref.	
TR020001		5(2)(k)		TR020001/APP/4.08	
Drawing Number					Revision
<b>LLADCO-3C-ARP-SFA-SWI-DR-HY-0007</b>					<b>P01</b>
Project - Phase - Originator - Asset/Zone - Sub Asset - Type - Discp. - Number					



For continuation see drawing  
LLADCO-3C-ARP-SFA-SWI-DR-HY-0007

This drawing may contain mapping by permission of Ordnance Survey on behalf of HMSO © Crown Copyright and database rights 2022 Ordnance Survey 0100031673  
All structure positions are indicative. The proposed works will be subject to detailed design development. The changes will be within limits of deviation specified in the Development Consent Order.

### KEY

-  Public Footpaths to be Stopped Up
-  Public Bridleways to be Stopped Up

### NOTES

- Points shown on drawing relate to DCO Schedule 3 reference

BW37 stopped up by airport proposals

DCO Submission	NS	JR	RG	27/02/23	P01
Revision History	Drawn	Checked Approved	Date	Rev.	



Luton Rising  
Hart House Business Centre  
Kimpton Road, Luton, LU2 0LA  
www.lutonrising.org.uk

## London Luton Airport Expansion Development Consent Order

Drawing Title

**RIGHTS OF WAY PLANS  
PERMANENT STOPPING UP OF  
PUBLIC RIGHTS OF WAY  
- SHEET 3 OF 6**

Purpose of issue				Suitability	
<b>DCO SUBMISSION</b>				S6	
Drawn	Checked	Approved	Date	Scale	Size
N.Scott	J.Riat	R.Goodall	27/02/23	1:1000	A3
DCO Application Ref.		APFP Regulation	DCO Document Ref.		
TR020001		5(2)(k)	TR020001/APP/4.08		

Drawing Number	Revision
<b>LLADCO-3C-ARP-SFA-SWI-DR-HY-0008</b>	<b>P01</b>
Project - Phase - Originator - Asset/Zone - Sub Asset - Type - Discp. - Number	

### Keyplan:

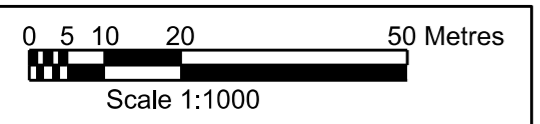
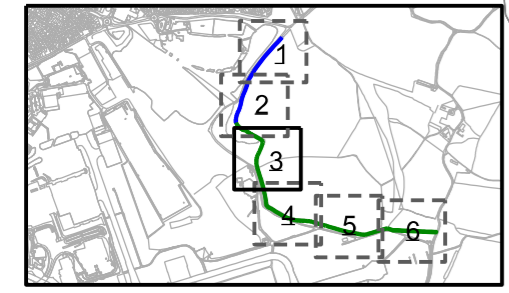

For continuation see drawing  
LLADCO-3C-ARP-SFA-SWI-DR-HY-0009



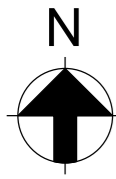

For continuation see drawing  
LLADCO-3C-ARP-SFA-SWI-DR-HY-0008



BW37 stopped up by  
airport proposals

For continuation see drawing  
LLADCO-3C-ARP-SFA-SWI-DR-HY-0010

This drawing may contain mapping by permission of Ordnance Survey on behalf of  
HMSO © Crown Copyright and database rights 2022 Ordnance Survey 0100031673

All structure positions are indicative. The proposed works will be subject to detailed  
design development. The changes will be within limits of deviation specified in the  
Development Consent Order.

### KEY

-  Public Footpaths to be Stopped Up
-  Public Bridleways to be Stopped Up

### NOTES

- Points shown on drawing relate to DCO Schedule 3 reference

DCO Submission	NS	JR	RG	27/02/23	P01
Revision History	Drawn	Checked Approved	Date	Rev.	



Our airport.  
Our community  
Our planet.

Luton Rising  
Hart House Business Centre  
Kimpton Road, Luton, LU2 0LA  
www.lutonrising.org.uk

## London Luton Airport Expansion Development Consent Order

Drawing Title  
**RIGHTS OF WAY PLANS  
PERMANENT STOPPING UP OF  
PUBLIC RIGHTS OF WAY  
- SHEET 4 OF 6**

Purpose of issue	Suitability
<b>DCO SUBMISSION</b>	S6

Drawn	Checked	Approved	Date	Scale	Size
N.Scott	J.Riat	R.Goodall	27/02/23	1:1000	A3

DCO Application Ref.	APFP Regulation	DCO Document Ref.
TR020001	5(2)(k)	TR020001/APP/4.08

Drawing Number	Revision
<b>LLADCO-3C-ARP-SFA-SWI-DR-HY-0009</b>	<b>P01</b>

Project - Phase - Originator - Asset/Zone - Sub Asset - Type - Discp. - Number

### Keyplan:

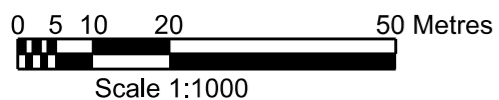
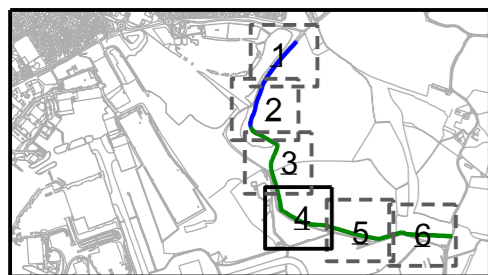



For continuation see drawing  
LLADCO-3C-ARP-SFA-SWI-DR-HY-0009

For continuation see drawing  
LLADCO-3C-ARP-SFA-SWI-DR-HY-0011

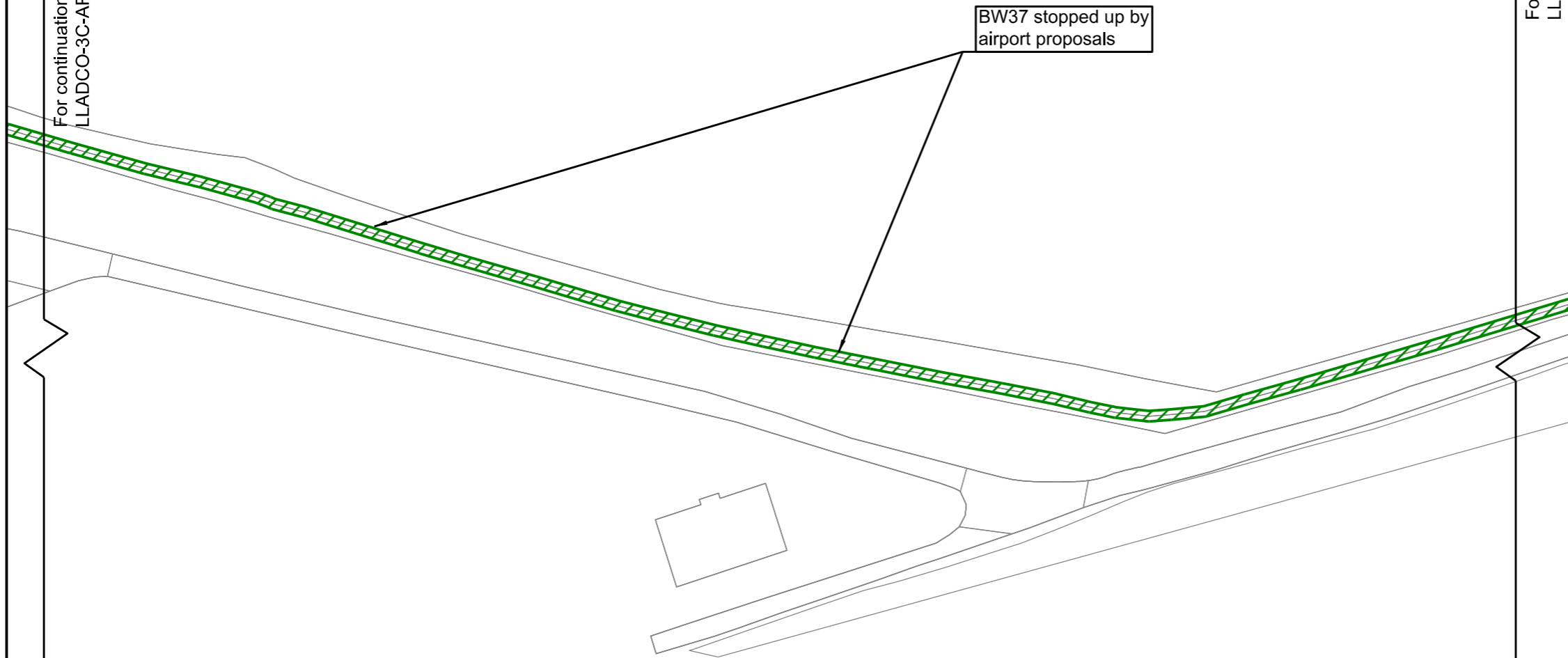

This drawing may contain mapping by permission of Ordnance Survey on behalf of HMSO © Crown Copyright and database rights 2022 Ordnance Survey 0100031673 □  
All structure positions are indicative. The proposed works will be subject to detailed design development. The changes will be within limits of deviation specified in the Development Consent Order.

### KEY

- Public Footpaths to be Stopped Up
- Public Bridleways to be Stopped Up

### NOTES

1. Points shown on drawing relate to DCO Schedule 3 reference

DCO Submission	NS	JR	RG	27/02/23	P01
Revision History	Drawn	Checked	Approved	Date	Rev.



Luton Rising  
Hart House Business Centre  
Kimpton Road, Luton, LU2 0LA  
www.lutonrising.org.uk

## London Luton Airport Expansion Development Consent Order

Drawing Title  
**RIGHTS OF WAY PLANS  
PERMANENT STOPPING UP OF  
PUBLIC RIGHTS OF WAY  
- SHEET 5 OF 6**

Purpose of issue	Suitability
<b>DCO SUBMISSION</b>	S6

Drawn	Checked	Approved	Date	Scale	Size
N.Scott	J.Riat	R.Goodall	27/02/23	1:1000	A3

DCO Application Ref.	APFP Regulation	DCO Document Ref.
TR020001	5(2)(k)	TR020001/APP/4.08

Drawing Number	Revision
<b>LLADCO-3C-ARP-SFA-SWI-DR-HY-0010</b>	<b>P01</b>
Project - Phase - Originator - Asset/Zone - Sub Asset - Type - Discp. - Number	

### Keyplan:

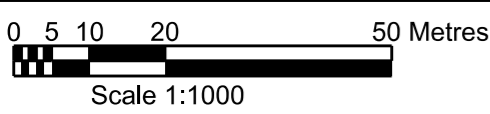
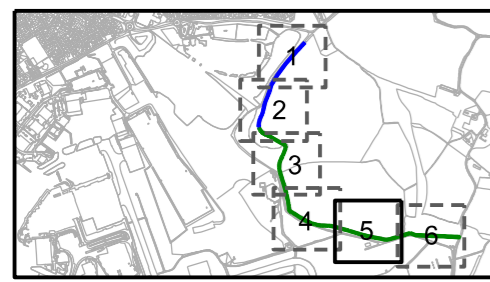

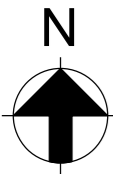

For continuation see drawing  
LLADCO-3C-ARP-SFA-SWI-DR-HY-0010

BW37 stopped up by  
airport proposals

Point E

### Keyplan:

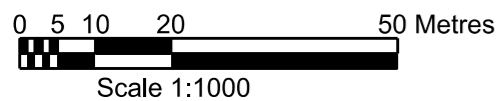
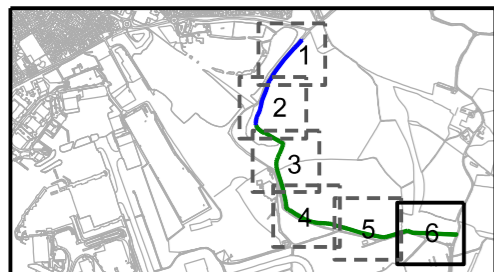

This drawing may contain mapping by permission of Ordnance Survey on behalf of HMSO © Crown Copyright and database rights 2022 Ordnance Survey 0100031673

All structure positions are indicative. The proposed works will be subject to detailed design development. The changes will be within limits of deviation specified in the Development Consent Order.

### KEY



Public Footpaths to be Stopped Up



Public Bridleways to be Stopped Up

### NOTES

- Points shown on drawing relate to DCO Schedule 3 reference

DCO Submission	NS	JR	RG	27/02/23	P01
Revision History	Drawn	Checked	Approved	Date	Rev.



Luton Rising  
Hart House Business Centre  
Kimpton Road, Luton, LU2 0LA  
www.lutonrising.org.uk

## London Luton Airport Expansion Development Consent Order

Drawing Title  
**RIGHTS OF WAY PLANS  
PERMANENT STOPPING UP OF  
PUBLIC RIGHTS OF WAY  
- SHEET 6 OF 6**

Purpose of issue				Suitability	
<b>DCO SUBMISSION</b>				S6	
Drawn	Checked	Approved	Date	Scale	Size
N.Scott	J.Riat	R.Goodall	27/02/23	1:1000	A3
DCO Application Ref.		APFP Regulation	DCO Document Ref.		
TR020001		5(2)(k)	TR020001/APP/4.08		
Drawing Number					Revision
<b>LLADCO-3C-ARP-SFA-SWI-DR-HY-0011</b>					<b>P01</b>
Project - Phase - Originator - Asset/Zone - Sub Asset - Type - Discp. - Number					



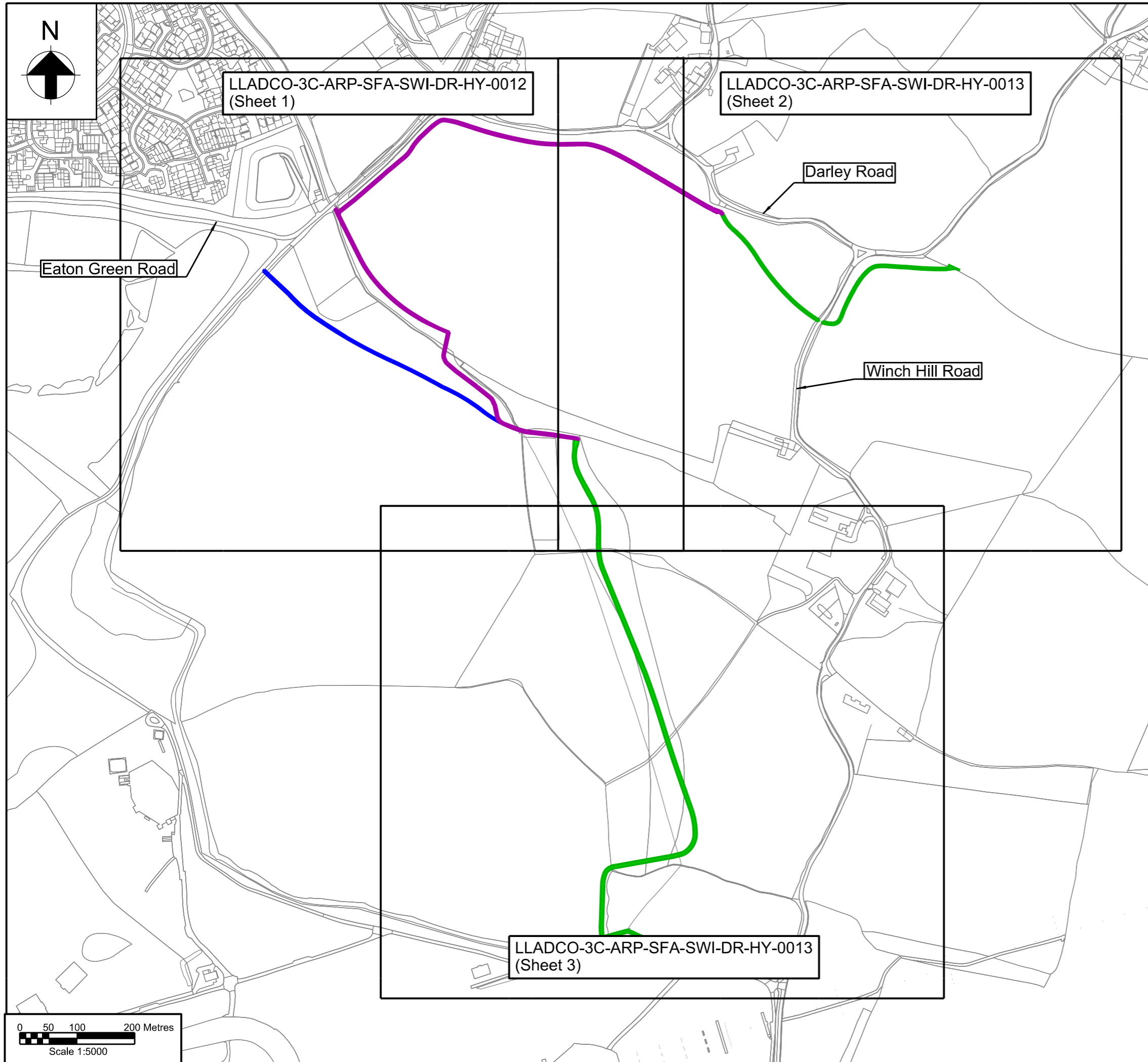

This drawing may contain mapping by permission of Ordnance Survey on behalf of HMSO © Crown Copyright and database rights 2022 Ordnance Survey 0100031673

All structure positions are indicative. The proposed works will be subject to detailed design development. The changes will be within limits of deviation specified in the Development Consent Order.

## NOTES

- For proposed Public Rights of Way, see LLADCO-3C-ARP-SFA-SWI-DR-HY-0012 to -0014

DCO Submission	NS	JR	RG	27/02/23	P01
Revision History	Drawn	Checked	Approved	Date	Rev.

**Luton Rising**  
 Our airport. Our community. Our planet.  
 Luton Rising  
 Hart House Business Centre  
 Kimpton Road, Luton, LU2 0LA  
 www.lutonrising.org.uk

### London Luton Airport Development Consent Order

Drawing Title

## RIGHTS OF WAY PLANS - PUBLIC RIGHTS OF WAY PROPOSALS KEYPLAN

Purpose of issue				Suitability	
DCO SUBMISSION				S6	
Drawn	Checked	Approved	Date	Scale	Size
N.Scott	J.Riat	R.Goodall	27/02/23	1:5000	A3
DCO Application Ref.		APFP Regulation	DCO Document Ref.		
TR020001		5(2)(k)	TR020001/APP/4.08		
Drawing Number					Revision
LLADCO-3C-ARP-SFA-SWI-DR-HY-0200					P01
Project - Phase - Originator - Asset/Zone - Sub Asset - Type - Discp. - Number					

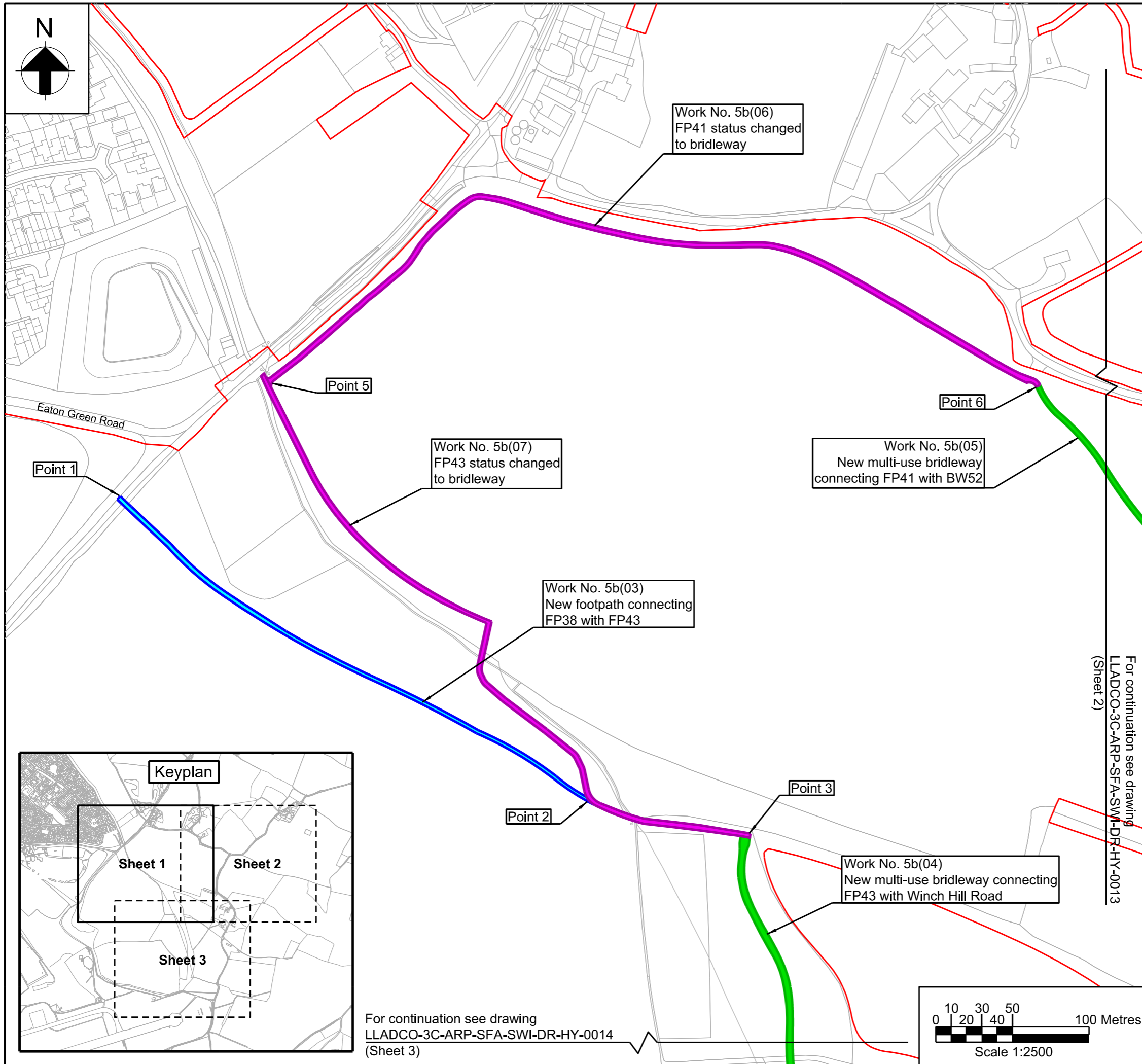

This drawing may contain mapping by permission of Ordnance Survey on behalf of HMSO © Crown Copyright and database rights 2022 Ordnance Survey 0100031673

All structure positions are indicative. The proposed works will be subject to detailed design development. The changes will be within limits of deviation specified in the Development Consent Order.

**KEY**

- Order Limits
- New Lengths of Footway
- New Lengths of Bridleway
- Footpath Status Changed to Bridleway

**NOTES**

1. Points shown on drawing relate to Schedule 4 references for the creation of new PRoWs or changes in status of existing PRoWs.

DCO Submission	NS	JR	RG	27/02/23	P01
Revision History	Drawn	Checked	Approved	Date	Rev.

**Luton Rising**  
 Our airport. Our community. Our planet.  
 Luton Rising  
 Hart House Business Centre  
 Kimpton Road, Luton, LU2 0LA  
 www.lutonrising.org.uk

**London Luton Airport Expansion Development Consent Order**

Drawing Title  
**RIGHTS OF WAY PLANS - PUBLIC RIGHTS OF WAY PROPOSALS SHEET 1 OF 3**

Purpose of issue				Suitability	
<b>DCO SUBMISSION</b>				S6	
Drawn	Checked	Approved	Date	Scale	Size
N.Scott	N.Scott	N.Scott	27/02/23	1:2500	A3
DCO Application Ref.		APFP Regulation	DCO Document Ref.		
TR020001		5(2)(k)	TR020001/APP/4.08		
Drawing Number					Revision
<b>LLADCO-3C-ARP-SFA-SWI-DR-HY-0012</b>					<b>P01</b>
Project - Phase - Originator - Asset/Zone - Sub Asset - Type - Discp. - Number					

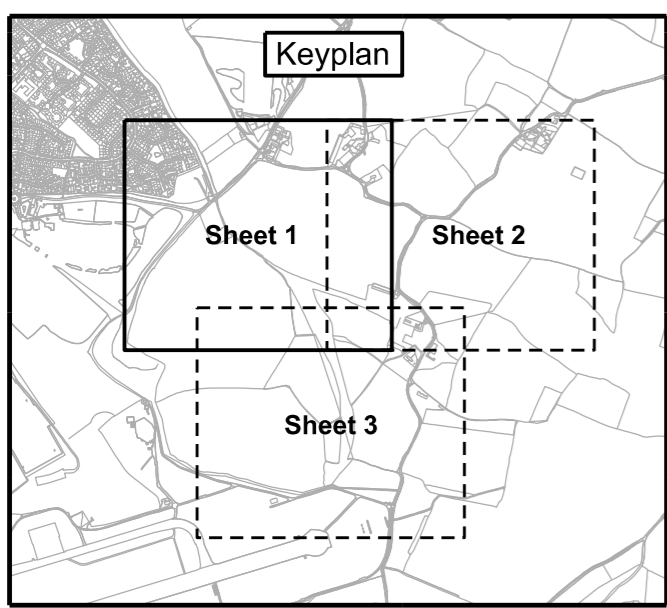

For continuation see drawing  
 LLADCO-3C-ARP-SFA-SWI-DR-HY-0014  
 (Sheet 3)

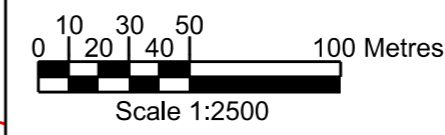

For continuation see drawing  
 LLADCO-3C-ARP-SFA-SWI-DR-HY-0013  
 (Sheet 2)

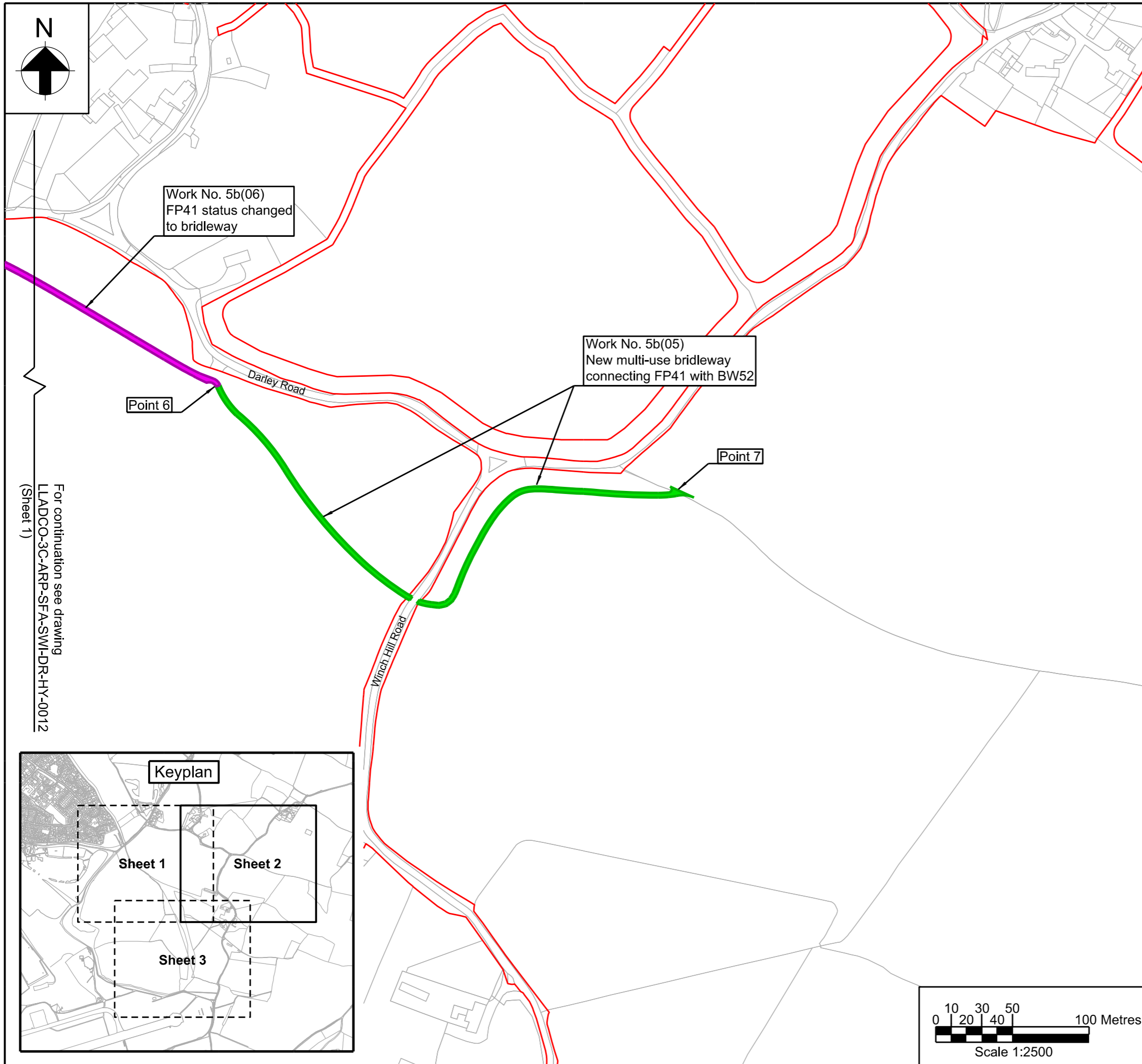

For continuation see drawing  
LLADCO-3C-ARP-SFA-SWI-DR-HY-0012  
(Sheet 1)

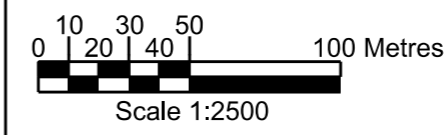
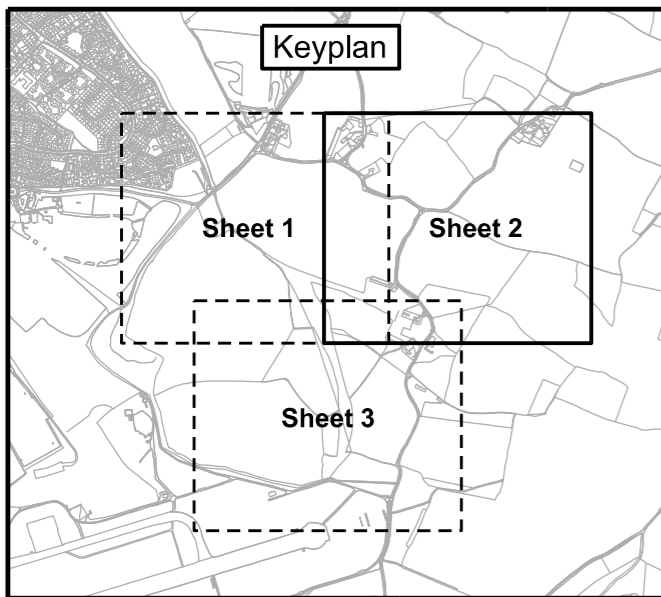

This drawing may contain mapping by permission of Ordnance Survey on behalf of HMSO © Crown Copyright and database rights 2022 Ordnance Survey 0100031673

All structure positions are indicative. The proposed works will be subject to detailed design development. The changes will be within limits of deviation specified in the Development Consent Order.

**KEY**

- Order Limits
- New Lengths of Footway
- New Lengths of Bridleway
- Footpath Status Changed to Bridleway

**NOTES**

1. Points shown on drawing relate to Schedule 4 references for the creation of new PRoWs or changes in status of existing PRoWs.

DCO Submission	NS	JR	RG	27/02/23	P01
Revision History	Drawn	Checked	Approved	Date	Rev.

Luton Rising  
Hart House Business Centre  
Kimpton Road, Luton, LU2 0LA  
www.lutonrising.org.uk

**London Luton Airport Expansion  
Development Consent Order**

Drawing Title  
**RIGHTS OF WAY PLANS  
- PUBLIC RIGHTS OF  
WAY PROPOSALS  
SHEET 2 OF 3**

Purpose of issue				Suitability	
<b>DCO SUBMISSION</b>				S6	
Drawn	Checked	Approved	Date	Scale	Size
N.Scott	N.Scott	N.Scott	27/02/23	1:2500	A3
DCO Application Ref.		APFP Regulation	DCO Document Ref.		
TR020001		5(2)(k)	TR020001/APP/4.08		
Drawing Number					Revision
<b>LLADCO-3C-ARP-SFA-SWI-DR-HY-0013</b>					<b>P01</b>
Project - Phase - Originator - Asset/Zone - Sub Asset - Type - Discp. - Number					



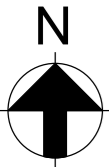

For continuation see drawing  
LLADCO-3C-ARP-SFA-SWI-DR-HY-0012  
(Sheet 1)

Work No. 5b(04)  
New multi-use bridleway connecting  
FP43 with Winch Hill Road

Winch Hill Road

Point 4

This drawing may contain mapping by permission of Ordnance Survey on behalf of HMSO © Crown Copyright and database rights 2022 Ordnance Survey 0100031673

All structure positions are indicative. The proposed works will be subject to detailed design development. The changes will be within limits of deviation specified in the Development Consent Order.

### KEY

- Order Limits
- New Lengths of Footway
- New Lengths of Bridleway
- Footpath Status Changed to Bridleway

### NOTES

1. Points shown on drawing relate to Schedule 4 references for the creation of new PRoWs or changes in status of existing PRoWs.

DCO Submission	NS	JR	RG	27/02/23	P01
Revision History	Drawn	Checked	Approved	Date	Rev.



Luton Rising  
Hart House Business Centre  
Kimpton Road, Luton, LU2 0LA  
www.lutonrising.org.uk

## London Luton Airport Expansion Development Consent Order

Drawing Title  
**RIGHTS OF WAY PLANS  
- PUBLIC RIGHTS OF  
WAY PROPOSALS  
SHEET 3 OF 3**

Purpose of issue				Suitability	
<b>DCO SUBMISSION</b>				S6	
Drawn	Checked	Approved	Date	Scale	Size
N.Scott	N.Scott	N.Scott	27/02/23	1:2500	A3
DCO Application Ref.		APFP Regulation	DCO Document Ref.		
TR020001		5(2)(k)	TR020001/APP/4.08		
Drawing Number					Revision
<b>LLADCO-3C-ARP-SFA-SWI-DR-HY-0014</b>					<b>P01</b>
Project - Phase - Originator - Asset/Zone - Sub Asset - Type - Discp. - Number					

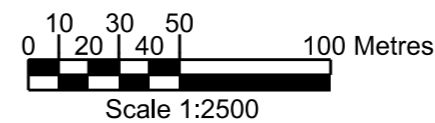
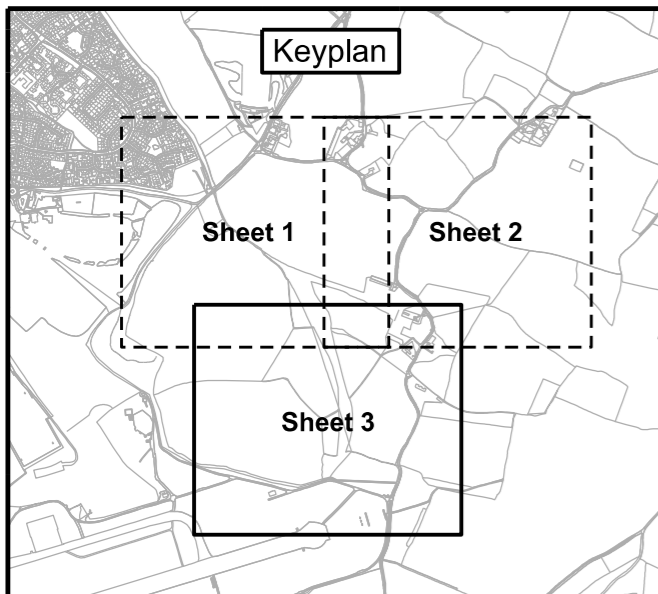



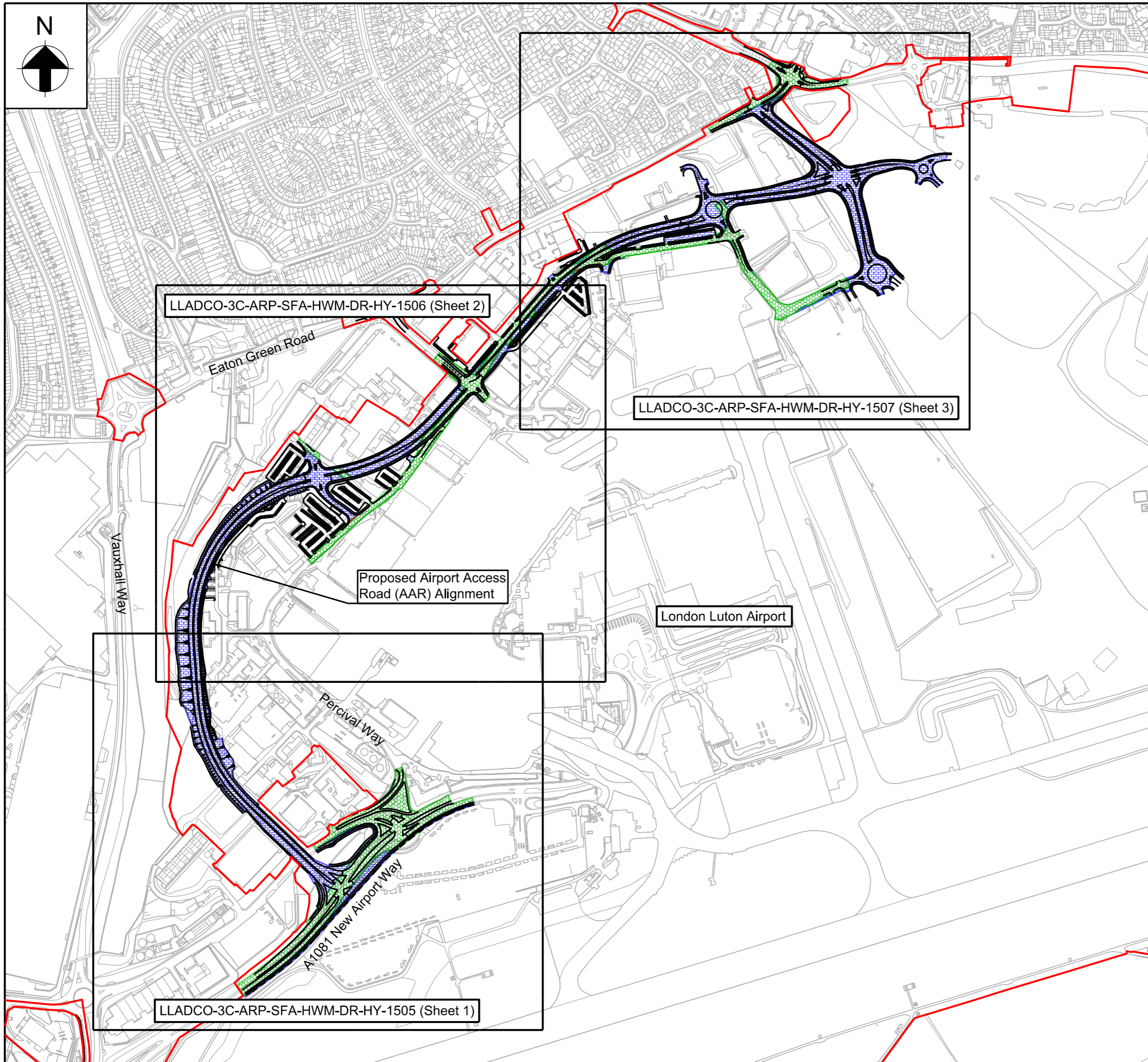
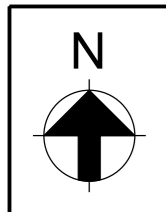

This drawing may contain mapping by permission of Ordnance Survey on behalf of HMSO © Crown Copyright and database rights 2022 Ordnance Survey 0100031673

All structure positions are indicative. The proposed works will be subject to detailed design development. The changes will be within limits of deviation specified in the Development Consent Order.

### NOTES

1. For Streets, Rights of Way and Access Plans see LLADCO-3C-ARP-SFA-HWM-DR-HY-1505 to -1507

DCO Submission	NS	JR	RG	27/02/23	P01
Revision History	Drawn	Checked	Approved	Date	Rev.



Luton Rising  
Hart House Business Centre  
Kimpton Road, Luton, LU2 0LA  
www.lutonrising.org.uk

## London Luton Airport Development Consent Order

Drawing Title  
**STREETS, RIGHTS OF WAY  
AND ACCESS PLAN  
- AIRPORT ACCESS ROAD  
KEYPLAN**

Purpose of issue				Suitability	
<b>DCO SUBMISSION</b>				S6	
Drawn	Checked	Approved	Date	Scale	Size
N.Scott	J.Riat	R.Goodall	27/02/23	NTS	A3
DCO Application Ref.		APFP Regulation		DCO Document Ref.	
TR020001		5(2)(K)		TR020001/APP/4.08	
Drawing Number					Revision
<b>LLADCO-3C-ARP-SFA-SWI-DR-HY-1500</b>					<b>P01</b>
Project - Phase - Originator - Asset/Zone - Sub Asset - Type - Discp. - Number					



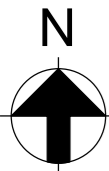



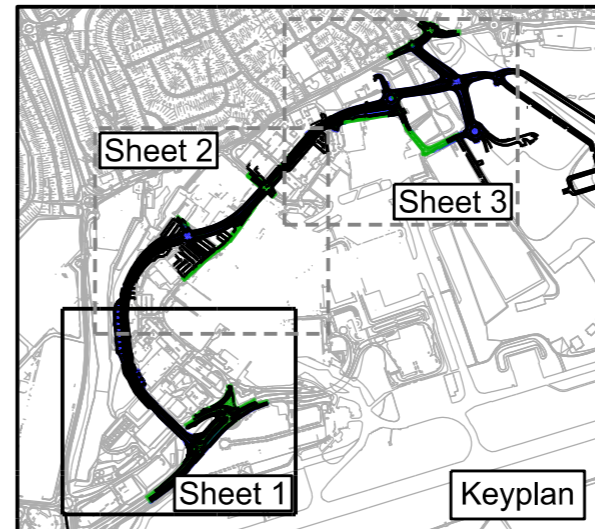

For continuation see drawing  
LLADCO-3C-ARP-SFA-HWM-DR-HY-1506  
(Sheet 2)



This drawing may contain mapping by permission of Ordnance Survey on behalf of HMSO © Crown Copyright and database rights 2022 Ordnance Survey 0100031673

All structure positions are indicative. The proposed works will be subject to detailed design development. The changes will be within limits of deviation specified in the Development Consent Order.

### KEY

-  Area of Improvement / Alteration to Existing Highway
-  Area of Proposed New Highway (Airport Access Road)
-  Proposed Carriageway / Footway Alignment
-  Order Limits

### NOTES

1. For Streets, Rights of Way and Access Plans for Airport Roads see drawings LLADCO-3C-ARP-SFA-HWM-DR-HY-1508 and -1509

DCO Submission	NS	JR	RG	27/02/23	P01
Revision History	Drawn	Checked	Approved	Date	Rev.



Luton Rising  
Hart House Business Centre  
Kimpton Road, Luton, LU2 0LA  
www.lutonrising.org.uk

## London Luton Airport Expansion Development Consent Order

Drawing Title

**STREETS, RIGHTS OF WAY AND ACCESS PLAN  
- AIRPORT ACCESS ROAD  
SHEET 1 OF 3**

Purpose of issue				Suitability	
<b>DCO SUBMISSION</b>				S6	
Drawn	Checked	Approved	Date	Scale	Size
N.Scott	J.Riat	R.Goodall	27/02/23	1:2500	A3
DCO Application Ref.		APFP Regulation	DCO Document Ref.		
TR020001		5(2)(k)	TR020001/APP/4.08		

Drawing Number	Revision
<b>LLADCO-3C-ARP-SFA-HWM-DR-HY-1505</b>	<b>P01</b>
Project - Phase - Originator - Asset/Zone - Sub Asset - Type - Discp. - Number	

Proposed Airport Access Road (AAR) Alignment

Airport Access Road

A1081 New Airport Way

Percival Way

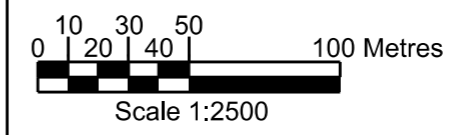



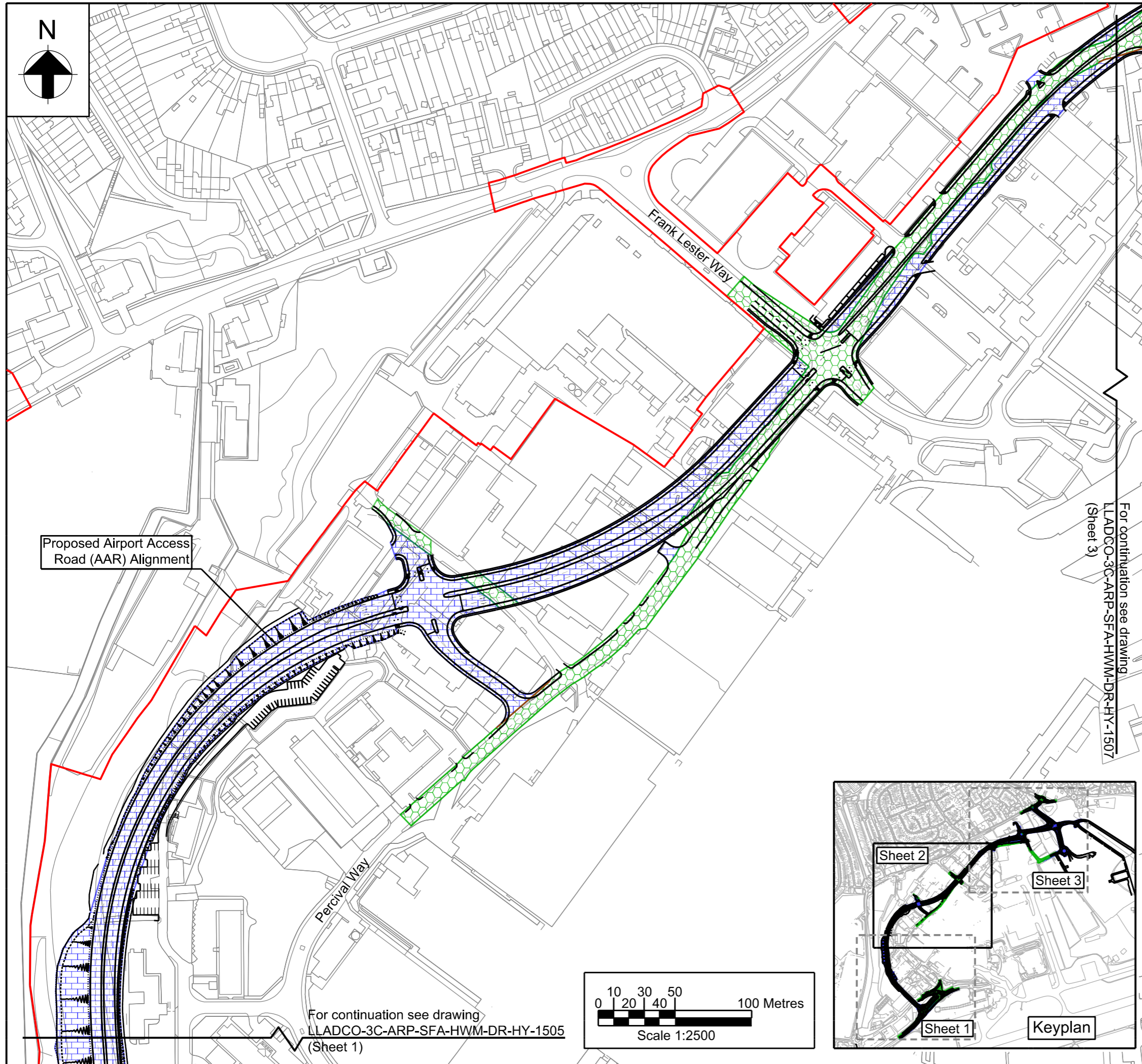

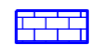

This drawing may contain mapping by permission of Ordnance Survey on behalf of HMSO © Crown Copyright and database rights 2022 Ordnance Survey 0100031673  
 All structure positions are indicative. The proposed works will be subject to detailed design development. The changes will be within limits of deviation specified in the Development Consent Order.

**KEY**

-  Area of Improvement / Alteration to Existing Highway
-  Area of Proposed New Highway (Airport Access Road)
-  Proposed Carriageway / Footway Alignment
-  Order Limits

**NOTES**

1. For Streets, Rights of Way and Access Plans for Airport Roads see drawings LLADCO-3C-ARP-SFA-HWM-DR-HY-1508 and -1509

DCO Submission	NS	JR	RG	27/02/23	P01
Revision History	Drawn	Checked	Approved	Date	Rev.

**Luton Rising** Our airport. Our community. Our planet.

Luton Rising  
 Hart House Business Centre  
 Kimpton Road, Luton, LU2 0LA  
[www.lutonrising.org.uk](http://www.lutonrising.org.uk)

**London Luton Airport Expansion Development Consent Order**

Drawing Title  
**STREETS, RIGHT OF WAY AND ACCESS PLANS - AIRPORT ACCESS ROAD SHEET 2 OF 3**

Purpose of issue				Suitability	
<b>DCO SUBMISSION</b>				S6	
Drawn	Checked	Approved	Date	Scale	Size
N.Scott	J.Riat	R.Goodall	27/02/23	1:2500	A3
DCO Application Ref.		APFP Regulation	DCO Document Ref.		
TR020001		5(2)(k)	TR020001/APP/4.08		

Drawing Number	Revision
<b>LLADCO-3C-ARP-SFA-HWM-DR-HY-1506</b>	<b>P01</b>
Project - Phase - Originator - Asset/Zone - Sub Asset - Type - Discp. - Number	

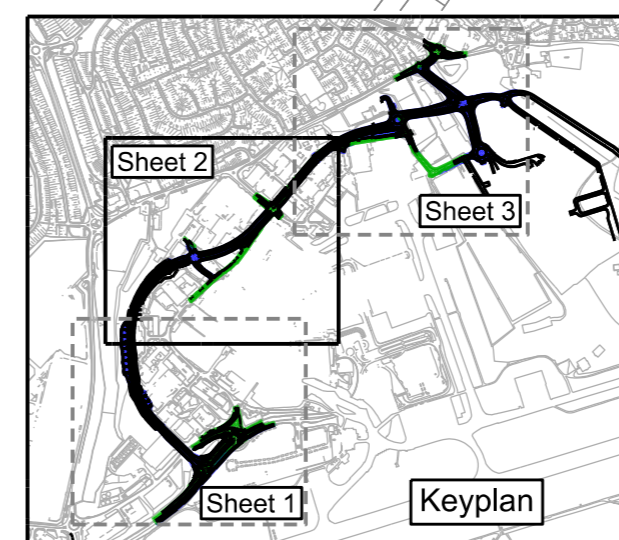

Proposed Airport Access Road (AAR) Alignment

For continuation see drawing LLADCO-3C-ARP-SFA-HWM-DR-HY-1505 (Sheet 1)

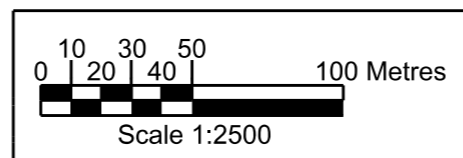

For continuation see drawing LLADCO-3C-ARP-SFA-HWM-DR-HY-1507 (Sheet 3)



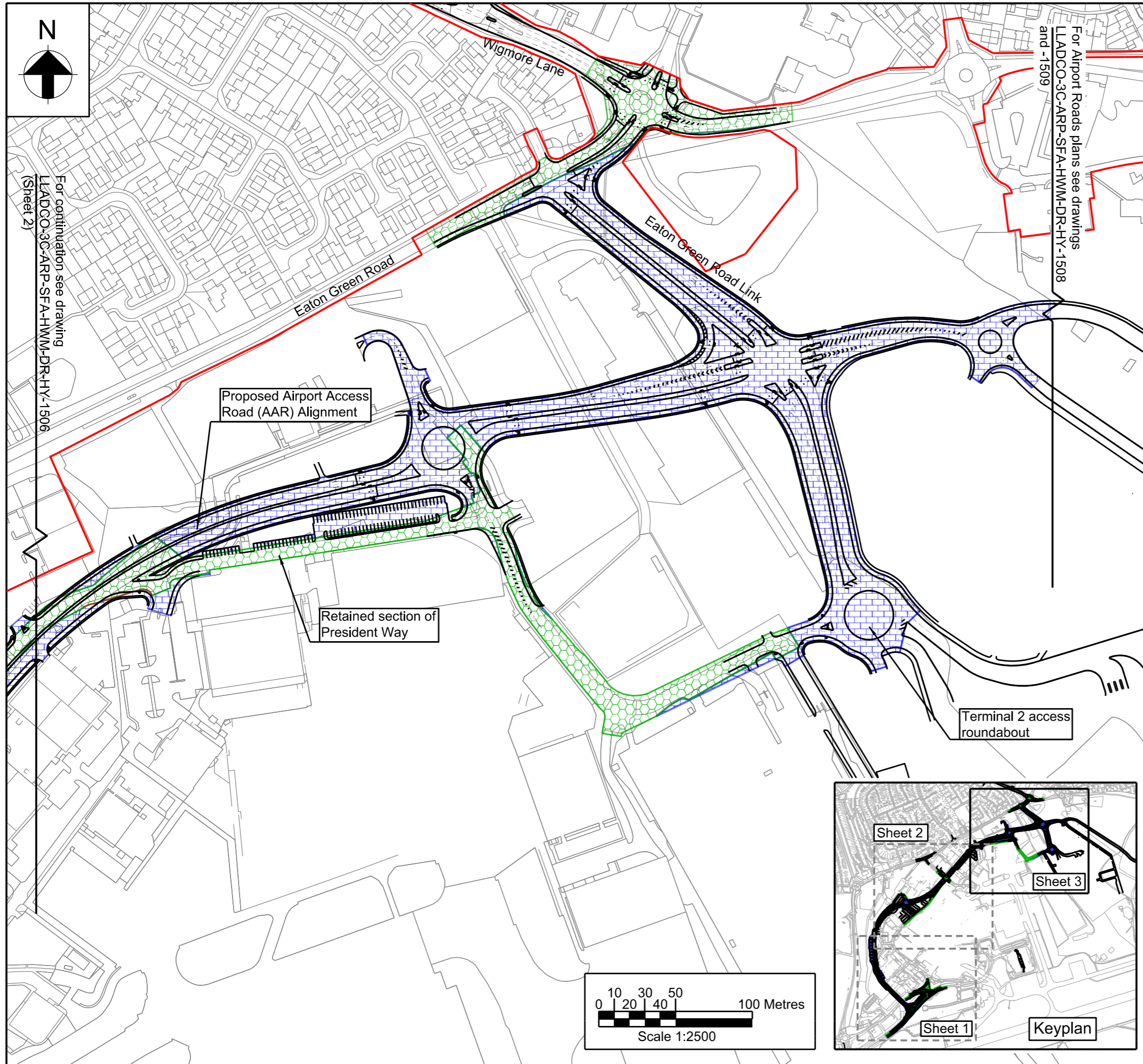

This drawing may contain mapping by permission of Ordnance Survey on behalf of HMSO © Crown Copyright and database rights 2022 Ordnance Survey 0100031673

All structure positions are indicative. The proposed works will be subject to detailed design development. The changes will be within limits of deviation specified in the Development Consent Order.

**KEY**

- Area of Improvement / Alteration to Existing Highway
- Area of Proposed New Highway (Airport Access Road)
- Proposed Carriageway / Footway Alignment
- Order Limits

**NOTES**

1. For Streets, Rights of Way and Access Plans for Airport Roads see drawings LLADCO-3C-ARP-SFA-HWM-DR-HY-1508 and -1509

DCO Submission	NS	JR	RG	27/02/23	P01
Revision History	Drawn	Checked	Approved	Date	Rev.

**Luton Rising**  
 Our airport. Our community. Our planet.  
 Luton Rising  
 Hart House Business Centre  
 Kimpton Road, Luton, LU2 0LA  
 www.lutonrising.org.uk

**London Luton Airport Expansion Development Consent Order**

Drawing Title  
**STREETS, RIGHTS OF WAY AND ACCESS PLANS - AIRPORT ACCESS ROAD SHEET 3 OF 3**

Purpose of issue				Suitability	
<b>DCO SUBMISSION</b>				S6	
Drawn	Checked	Approved	Date	Scale	Size
N.Scott	J.Riat	R.Goodall	27/02/23	1:2500	A3
DCO Application Ref.		APFP Regulation		DCO Document Ref.	
TR020001		5(2)(k)		TR020001/APP/4.08	
Drawing Number					Revision
<b>LLADCO-3C-ARP-SFA-HWM-DR-HY-1507</b>					<b>P01</b>
Project - Phase - Originator - Asset/Zone - Sub Asset - Type - Discp. - Number					



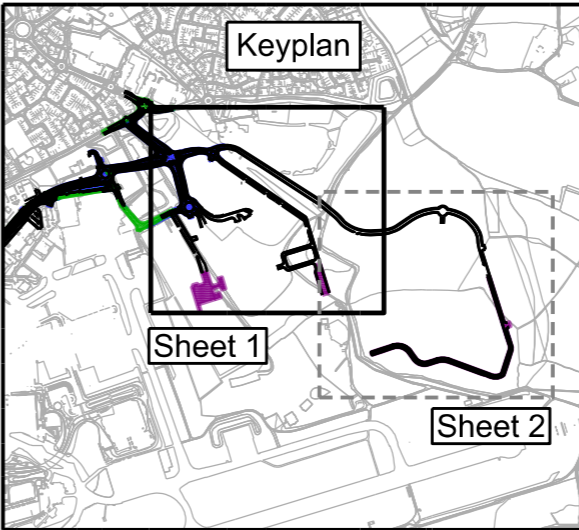
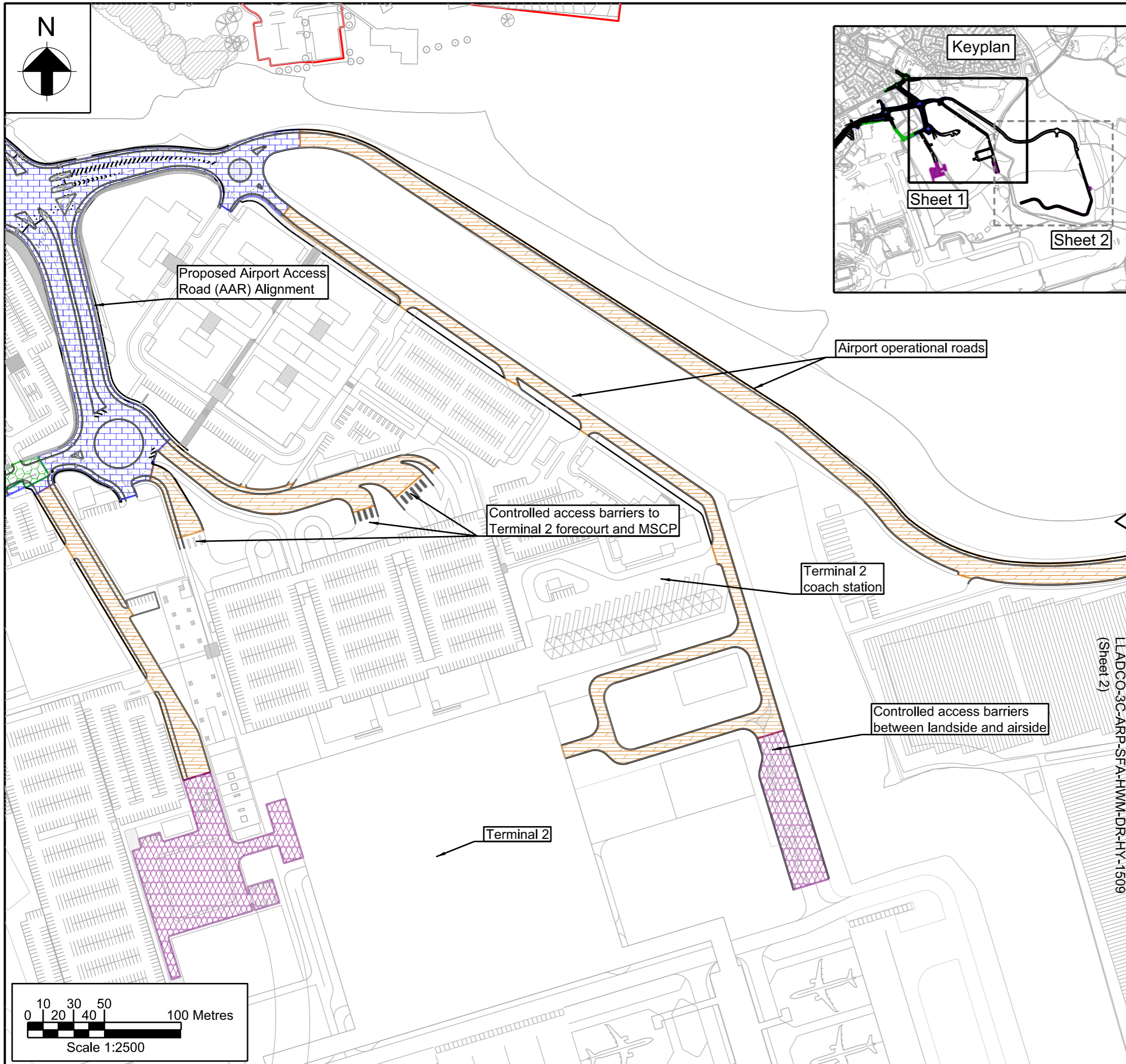

This drawing may contain mapping by permission of Ordnance Survey on behalf of HMSO © Crown Copyright and database rights 2022 Ordnance Survey 0100031673

All structure positions are indicative. The proposed works will be subject to detailed design development. The changes will be within limits of deviation specified in the Development Consent Order.

**KEY**

- Area of Proposed New Highway (Airport Access Road)
- Area of Proposed New Carriageway / Footway (Airport Operational Roads- Public Access)
- Area of Proposed New Carriageway / Footway (Airport Operational Roads- Controlled Access)
- Proposed Carriageway / Footway Alignment
- Order Limits

**NOTES**

1. For AAR Streets, Rights of Way and Access plans see drawings LLADCO-3C-ARP-SFA-HWM-DR-HY-1505 to -1507

DCO Submission	NS	JR	RG	27/02/23	P01
Revision History	Drawn	Checked	Approved	Date	Rev.

Luton Rising  
Our airport.  
Our community.  
Our planet.

Luton Rising  
Hart House Business Centre  
Kimpton Road, Luton, LU2 0LA  
www.lutonrising.org.uk

**London Luton Airport Expansion  
Development Consent Order**

Drawing Title

**STREETS, RIGHTS OF WAY  
AND ACCESS PLANS  
- AIRPORT ROADS  
SHEET 1 OF 2**

Purpose of issue				Suitability	
<b>DCO SUBMISSION</b>				S6	
Drawn	Checked	Approved	Date	Scale	Size
N.Scott	J.Riat	R.Goodall	27/02/23	1:2500	A3
DCO Application Ref.		APFP Regulation	DCO Document Ref.		
TR020001		5(2)(k)	TR020001/APP/4.08		
Drawing Number					Revision
<b>LLADCO-3C-ARP-SFA-HWM-DR-HY-1508</b>					<b>P01</b>
Project - Phase - Originator - Asset/Zone - Sub Asset - Type - Discp. - Number					

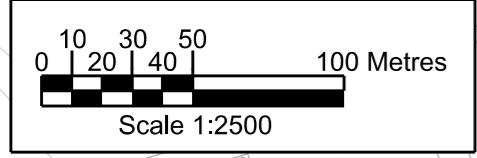



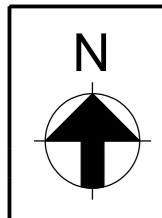

To / from Airport Access Road

Access to Car Park

Access to Car Park

Access to fuel farm

Controlled access to airside  
for authorised vehicles only



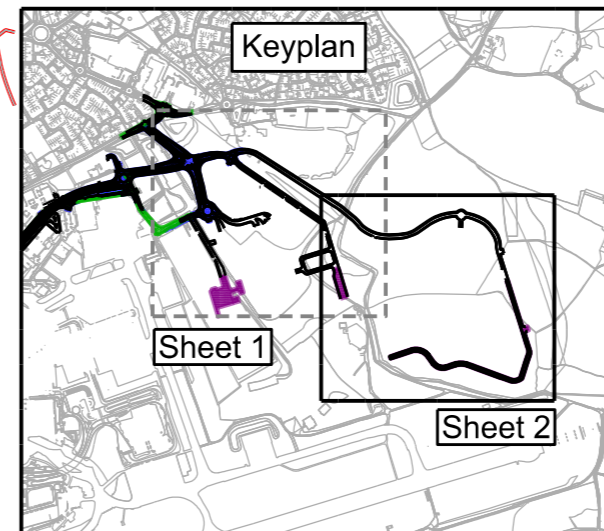

For continuation see drawing  
LLADCO-3C-ARP-SFA-HWM-DR-HY-1508  
(Sheet 1)

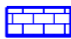

This drawing may contain mapping by permission of Ordnance Survey on behalf of HMSO © Crown Copyright and database rights 2022 Ordnance Survey 0100031673

All structure positions are indicative. The proposed works will be subject to detailed design development. The changes will be within limits of deviation specified in the Development Consent Order.

### KEY

-  Area of Proposed New Highway (Airport Access Road)
-  Area of Proposed New Carriageway / Footway (Airport Operational Roads- Public Access)
-  Area of Proposed New Carriageway / Footway (Airport Operational Roads- Controlled Access)
-  Proposed Carriageway / Footway Alignment
-  Order Limits

### NOTES

1. For AAR Streets, Rights of Way and Access plans see drawings LLADCO-3C-ARP-SFA-HWM-DR-HY-1505 to -1507

DCO Submission	NS	JR	RG	27/02/23	P01
Revision History	Drawn	Checked Approved	Date	Rev.	



Luton Rising  
Hart House Business Centre  
Kimpton Road, Luton, LU2 0LA  
www.lutonrising.org.uk

## London Luton Airport Expansion Development Consent Order

Drawing Title

**STREETS, RIGHTS OF WAY  
AND ACCESS PLANS  
- AIRPORT ROADS  
SHEET 2 OF 2**

Purpose of issue				Suitability	
<b>DCO SUBMISSION</b>				S6	
Drawn	Checked	Approved	Date	Scale	Size
N.Scott	J.Riat	R.Goodall	27/02/23	1:2500	A3
DCO Application Ref.		APFP Regulation	DCO Document Ref.		
TR020001		5(2)(k)	TR020001/APP/4.08		
Drawing Number					Revision
<b>LLADCO-3C-ARP-SFA-HWM-DR-HY-1509</b>					<b>P01</b>
Project - Phase - Originator - Asset/Zone - Sub Asset - Type - Discp. - Number					

